

2018 BUICK ENCLAVE

#18-NA-178 - Electric Park Brake Inoperative or Service Park Brake Lamp On - (Jun 4, 2018)

Subject:

Electric Park Brake Inoperative or Service Park Brake Lamp On

Brand:	Model:	Model Year:		VIN:		Engine:	Transmission:
		from	to	from	to		
Buick	Enclave	2018	2018				
Cadillac	XT5						
Chevrolet	Traverse						
GMC	Acadia						

Involved Region or Country	North America and N.A.Exports
Condition 1	<p>Some customers may comment that the electric parking brake is inoperative.</p> <p>Some technicians may find one or more DTC set in the Electric Brake Control Module (EBCM):</p> <ul style="list-style-type: none">• C028F: Left Park Brake Actuator Circuit (C028F 04 06: Short to Ground)• C1586: Right Park Brake Actuator Circuit (C1586 04 06: Short to Ground)

Condition 2	<p>Some customers may comment that the electric parking brake is inoperative.</p> <p>Some technicians may find previous brake actuator repair.</p>
Condition 3	<p>Some customers may comment that the Service Park Brake lamp is on.</p> <p>Some technicians may find one or more DTC set in the Electric Brake Control Module (EBCM):</p> <ul style="list-style-type: none"> • C1587: Left Park Brake Actuator (C1587 0B: Software Sensitivity) • C1588: Right Park Brake Actuator (C1588 0B: Software Sensitivity)
Cause 1	<p>This condition may be caused by water leaking into the rear actuator, creating a short to ground.</p> <ul style="list-style-type: none"> • Electric Park Brake Actuator DTCs C028F 04 06 and/or C1586 04 06.
Cause 2	<p>This condition may be caused by software anomaly.</p>
Cause 3	<p>This condition may be caused by software sensitivity caused by a weak battery</p> <ul style="list-style-type: none"> • EBCM DTCs C1587 0B and/or C1588 0B set.
Correction 1	<p>If DTCs C028F 04 and/or C1586 04 are set, verify which EPB actuator set the DTC and replace the actuator per SI.</p>

①



②

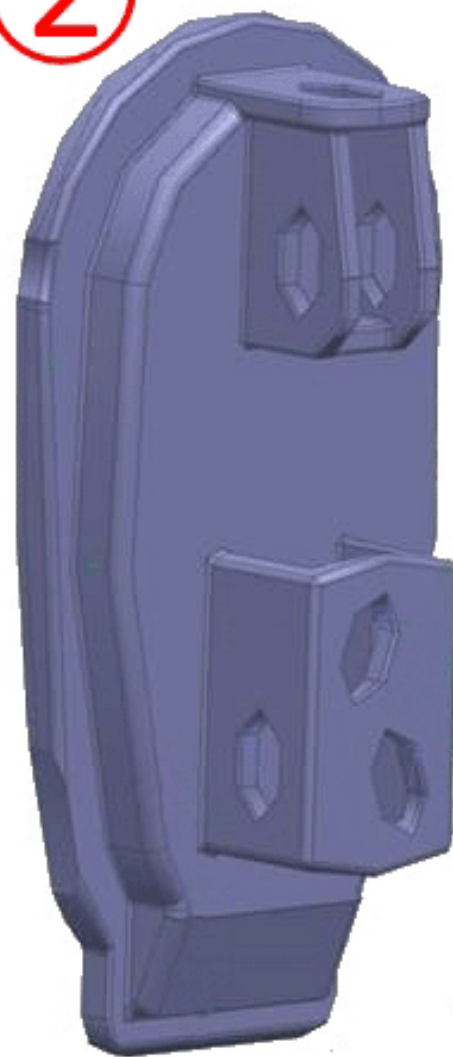

- **Note:**

When replacing the brake actuator. Verify that the brake actuator has the updated cover.

	<ul style="list-style-type: none"> • Old cover design (1). • New cover design (2).
Correction 2	If DTC's are not set and/or the brake actuators have been previously been replaced, program the EBCM to the latest calibration available.
Correction 3	If DTCs C1587 0B or C1588 0B are set, program the EBCM to the latest calibration available.

Service Procedure

Refer to Parking Brake Actuator Replacement in SI.

Important:

Stable battery voltage is critical during programming. Any fluctuation, spiking, over voltage or loss of voltage will interrupt programming. Install the EL-49642 SPS Programming Support Tool (GM Dealer Equipment Item #PSC-550) to maintain system voltage. If not available, connect a fully charged 12V jumper or booster pack disconnected from the AC voltage supply. DO NOT connect a battery charger.

Refer to K17 Electronic Brake Control Module: Programming and Setup in SI.

Parts Information

Causal Part	Description	Part Number	Qty
X	ACTUATOR KIT, RR PARK BRK	13516554	1

Warranty Information (Correction 1)

For vehicles repaired under warranty, use:

Labor Operation	Description	Labor Time
2450940	Parking Brake Actuator Replacement	Use the Published Labor Operations Time

Warranty Information (Correction 2 and 3)

For vehicles repaired under the Bumper-to-Bumper coverage (Canada Base Warranty coverage), use the following labor operation. Reference the Applicable Warranties section of Investigate Vehicle History (IVH) for coverage information.

Labor Operation	Description	Labor Time
2886058*	Electronic Brake Control Module Reprogramming with SPS	0.3 hr
*This is a unique Labor Operation for Bulletin use only.		

Version	2
Modified	Released June 04, 2018 Revised October 12, 2018 - Add Unique Labor Op for EBCM programming.